

PT-LP-S5 LP Servo Pan/Tilt Head



The PT-LP-S5 robotic pan tilt head represents the 5th generation of robotic camera systems from EVS. The S5 line includes EVS' advanced servo technology enabling higher payloads and smooth, quiet, on-air operation delivering breathtaking results.

The S5 series continues our longstanding support of high-resolution encoders for use in virtual reality applications where robotic cameras are desired.

The "snap-in" modular design enables quick, easy, and accurate setup and commissioning. The S5 line can automatically detect and warn when load balancing and power issues occur — preventing costly down time. The revolutionary construction and streamlined design support heavier payloads with a tremendously stable and reliable platform.

Perfectly suited for studio applications where mid to heavy weight payloads are required, the PT-LP-S5 supports mounting teleprompters, preview monitors, camera, lens, external tally, and count down clocks — all powered by our integrated cable and power management feature.

The head also provides both robotic and manual control over-rides for studio applications that demand the versatility.

Features

- Fully integrated servo motors with support for reFrame™ Automatic Shot Framing and Tracking, keyframe motion, and on-the-fly motion time changes
- Stable "dual-cradle" design for mechanical isolation of camera and teleprompter
- Supports a fully equipped studio payload
- Fast and quiet motion, up to 90°/sec
- Red and green tally lights
- Virtual set ready
- LED status indicators for power and health
- Local buttons to drive any axis and set soft-limits
- On-board local redundancy for camera and robotics control
- Embedded network switch provides convenient pass through for IP control of peripheral devices
- Web application for simple control, configuration and health monitoring
- Clean cable management



PT-LP-S5 LP Servo Pan/Tilt Head

ORDERING INFORMATION	
MODEL NUMBER	DESCRIPTION
PT-LP-S5 PAN/TILT HEAD BUNDLE	LP-S5 Pan/Tilt Head Power/Data Cable Lens Interface LP-S5 Universal Camera Mounting Kit PT-LP-S5 Number Insert #X (X = Cam Number) Cable LP-S5 TM Tally/Mon Pwr
PT-LP-S5 PAN/TILT HEAD W/ VIRTUAL BUNDLE	LP-S5 Pan/Tilt Head LP-S5 Virtual Studio Option Power/Data Cable Lens Interface LP-S5 Universal Camera Mounting Kit PT-LP-S5 Number Insert #X (X = Cam Number)
PT-LP-S5 PAN/TILT HEAD BUNDLE WITH MANUAL OPTION	LP-S5 Pan/Tilt Head LP-S5 Manual Friction Brake Option LP-S5 Single Manual Pan Bar Power/Data Cable Lens Interface LP-S5 Universal Camera Mounting Kit PT-LP-S5 Number Insert #X (X = Cam Number)
PS-PACK-48-160W	PS Packaged Pan/Tilt PS 48V
PS-RM-48-2	Rack Mount Dual Power Supply
CA-PWR-7XLR-xxx	Cable 48VPS 7XLR M/7XLR FM (xxx = Length/Feet)

Specifications and features are subject to change without prior notice.

SPECIFICATIONS	
MODEL NUMBER	DESCRIPTION
Pan Travel (Max)	+/-360° w/endstop (720° without end-stops)
Tilt Travel (Max)	+180° -180° (+25°, -15° with teleprompter) *
End Stop Resolution	Electronic smooth top
Velocity (Min/Max)	Pan 0.01° - 90°/sec; Tilt 0.01° - 90°/sec *
Stopping Accuracy	60 arc sec (0.016°)
Position Resolution	5,625 mil counts per 360° (23-bit)
Acceleration	90°/sec ² *
Virtual Option Feedback Accuracy	360° = 8000,000 Counts 0.00045 Deg/Count
Audible Noise	31 dB(A) max, IEC free field at velocity 60°/sec
Operating Modes	Velocity, position cut & fade w/ convergence, motion key frame, manual w/ option
Payload	90 lbs (40.8 kg) on center of mass
Weight	43 lbs (19.5 kgs) 55.6 lbs (25 kgs) w/manual brake option installed
Power In	38-53 Vdc (10A max)
Input Power Connector	7-pin male XLR
Camera Power Output	60 W (15 Vdc, 4A max)
Teleprompter & Talent Monitor Power Output	120 W (13.2 Vdc 9A max)
Temperature Range	Operating: 4 to 50°C (40 to 120°F) Storage: -30 to + 60°C (-22 to 140° F)
Tally	Red & green internal with external IO support
Virtual Data Output	Ethernet, UDP
Compatible Lenses	Analog teleconference & digital full servo lenses
Camera Direct Control of CCU function	Most broadcast camera brands and models. (Contact EVS for full list of supported models)

*Dependent on 3rd party equipment make and model

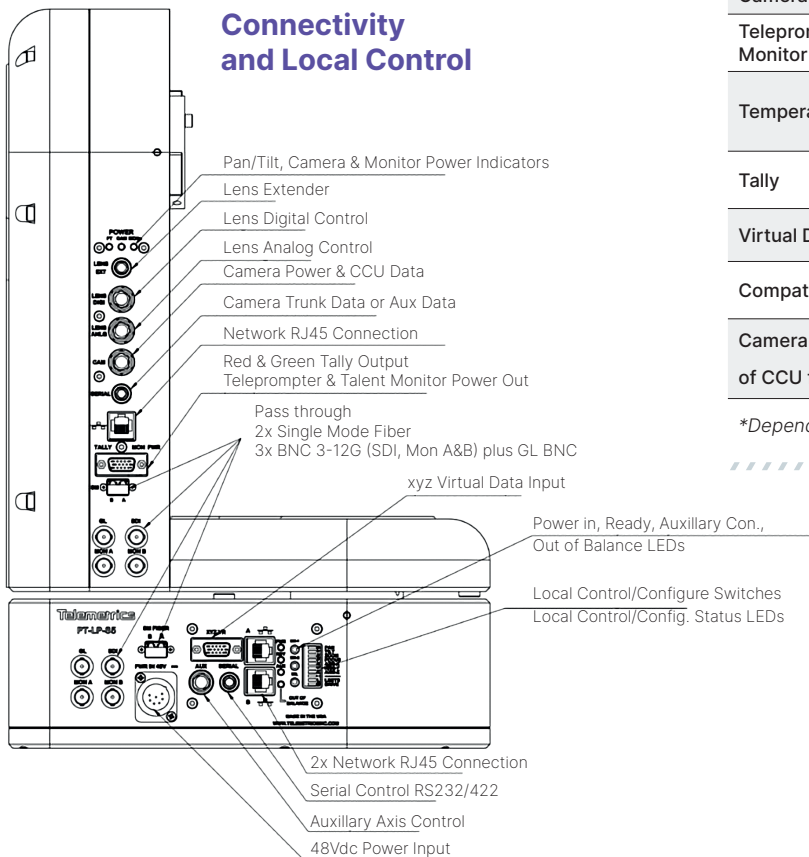

Standard Dimensions

Dimensions: [mm] in

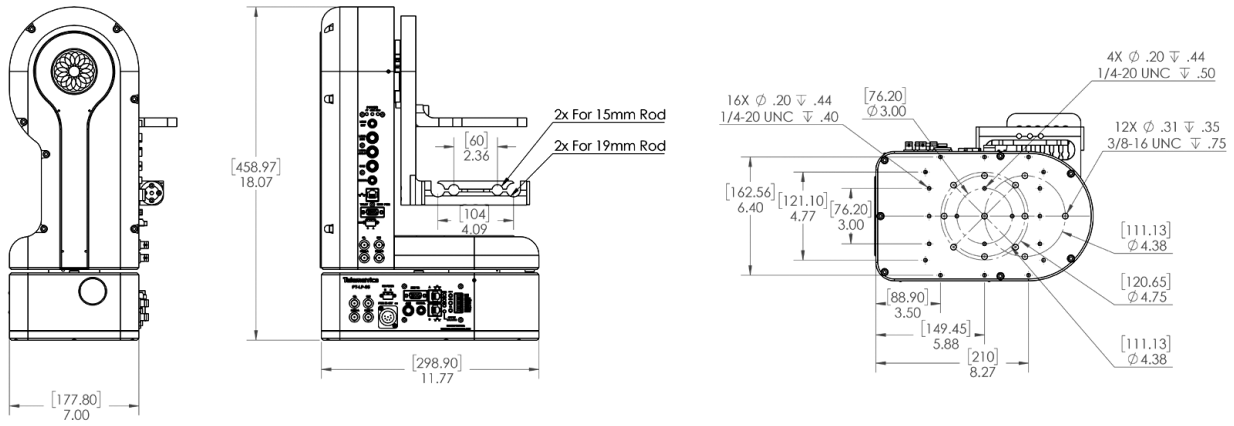

Dimensions with Manual Brake Option Installed

Dimensions: [mm] in

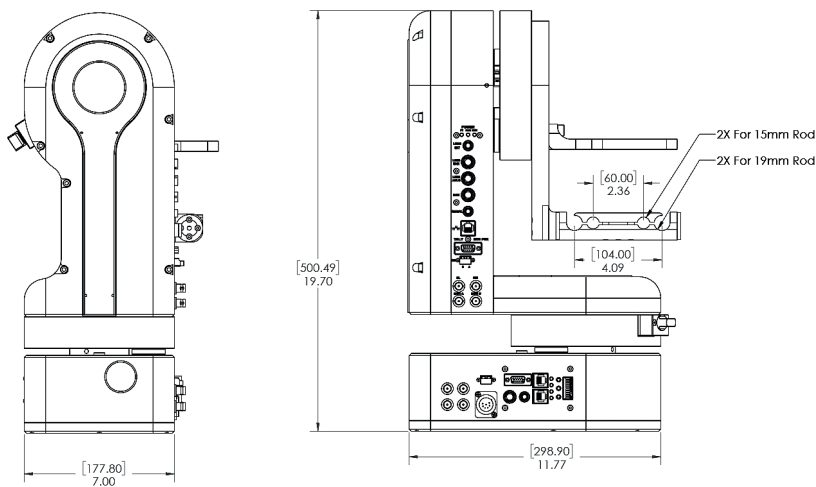

© 2021 EVS Broadcast Equipment, all rights reserved.



EVS is globally recognized as the leader in live video technology for broadcast and new media productions. Our passion and purpose are to help our clients craft immersive stories that trigger the best return on emotion. Through a wide range of products and solutions, we help deliver the most gripping live sports images, buzzing entertainment shows and breaking news content to millions of viewers every day – and in real-time.